

OLIVE FOIL

The Heaps have combined striking olive ash cabinetry with dark American walnut accents to balance their design



Ann-Marie's island is not only home to the hob but also doubles up as an area for her to work from home. Black Frag Zanzibar chairs from Stocktons add a contemporary touch to the organic scheme

“The room changes all the time with the light and just improves as it wears. I love how the two woods work together and in fact, everyone who comes in just says “wow”

ANN-MARIE HEAPS



DESIGN & CABINETRY

■ Darren Pincus at **Pincus Design**,
10 Woodfield Road, Altrincham, Cheshire
WA14 4EU (0161 941 6444)
www.pincusdesign.co.uk

■ Bespoke olive ash veneer furniture
with glass cabinetry

WORKTOPS

■ Star Galaxy granite. Price per sq m **£727**
■ Solid American walnut. Price per sq m **£727**

SINKS & TAP

■ GAX11045 Galassia single-bowl sink
in stainless steel, Franke **£114**
■ ARX11017 Ariane half-bowl sink
in stainless steel, Franke **£107**
■ Eiger monobloc mixer tap
in chrome, Franke **£151**

APPLIANCES (shown)

■ B4562 built-in single pyrolytic oven, Neff **£788**
■ H5972 built-in combination
microwave, Neff **£650**
■ T2766 five-burner gas hob, Neff **£310**
■ D91M5 island extractor hood in glass
and stainless steel, Neff **£727**

☎ For stockists, see page 161

FAVOURITE DESIGN ELEMENT: 'The island workstation – everyone comments on it. It really fulfils the living/working/eating credential we had in mind and I love the way it all comes together'



Designer Darren created a dresser and wine storage unit from the same olive ash as the kitchen to give continuity to the dining area. The Reflex glass table and Frag Sumbawa chairs from Stocktons echo the room's rounded edges, while Flair Blanco pale ceramic tiles from Tilemart create a neutral backdrop



Hoping to create a room that could be used for eating, cooking, living and entertaining, the first task for Ann-Marie Heaps, a managing director, and her husband John, a podiatrist, was to extend their Lancashire home. Once the work was under way, the couple's builder, Chris Maffei, recommended they visit Darren Pincus at Pincus Design to help with the layout.

'We were working from a blank canvas, something we weren't really convinced that we could do,' recalls Ann-Marie. 'Once we met Darren, we found ourselves becoming more creative. He picked up on exactly who we were and included quite a few ideas we hadn't thought of,' she continues.

Darren's first suggestion was to move the kitchen from one side of the room to the other, making it the focal point of the large space. However, the couple realised that the walnut they had envisaged would be far too dark. Instead, Darren proposed light olive ash units with walnut feature end panels.

'The room has so much character now and it's not something that will date,' explains Ann-Marie. 'I'm so glad Darren was recommended or we would have gone into any showroom. I think it would have been impossible to find anyone else to create such a unique kitchen.'



▼ The grain of the olive ash creates much of the drama in the couple's kitchen so needed simple details to complement it. These satin nickel Eero Aarnio curved handles by Valli Valli are ideal as they mimic the Neff ovens' stainless-steel finish and style

▲ The veneered cabinetry in Ann-Marie and John's kitchen has been sliced vertically from one piece of wood, so that the grain is mirrored. A dark American walnut island and a back-painted red glass splashback provide a rich contrast

▼ This smart American walnut overhang is an integral part of the island and is where Ann-Marie and John's guests often sit when the couple are preparing meals. 'It's the perfect place for casual meals with friends as well as entertaining,' smiles Ann-Marie

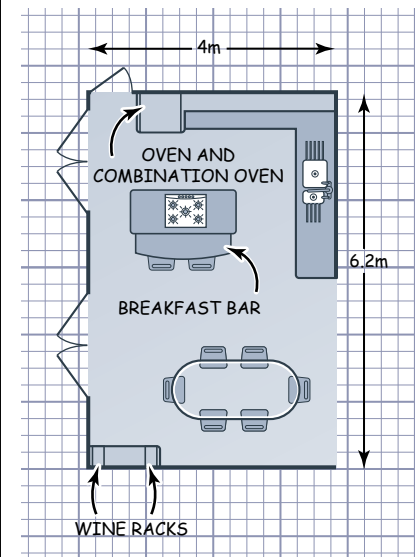
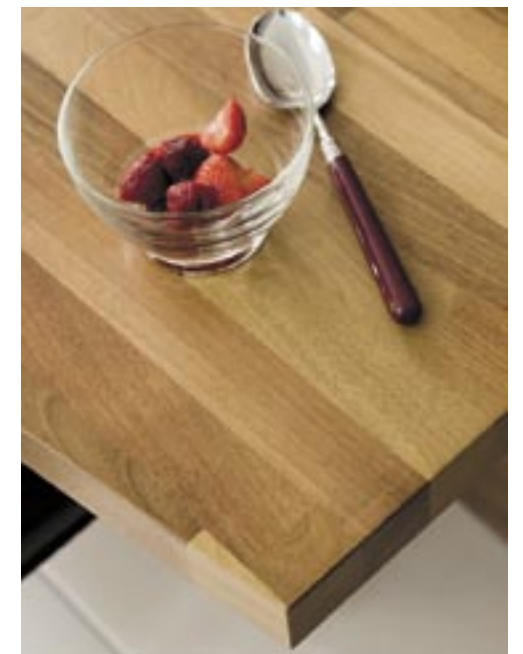
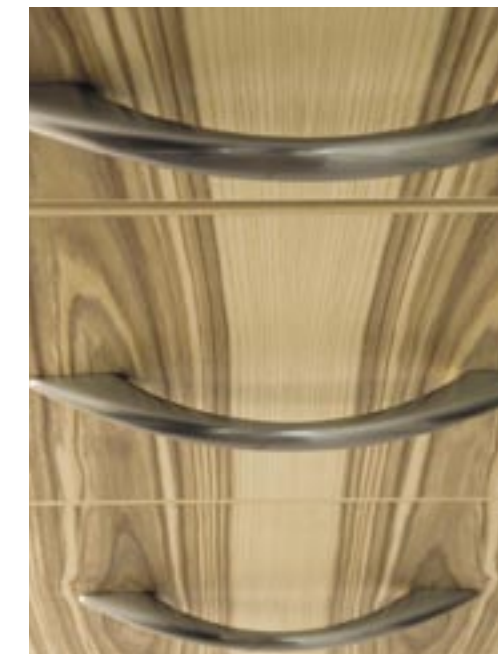

GUIDE PRICE

■ Starting price for a Pincus Design kitchen **£20,000**